

POULSBO PLACE II

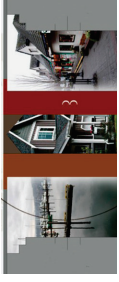

- Two Story with Basement/
Bonus Room
- 2 Car Garage



DOGWOOD

3 Level Town Home
 2 Bdrm / 2.5 Bath
 1648 SQ FT
 Main Floor: 684 sq ft
 Second Floor: 698 sq ft
 Ground Floor: 266 sq ft

\$249,000

Available on lots 263-272

www.PoulsboPlace2.com

Karen Bazar
 karenbazar@johnscott.com
 (360)981-0098

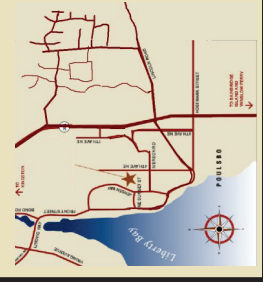

FLOOR PLANS, SQUARE FOOTAGE &
 RENDERINGS ARE PRELIMINARY &
 ARE SUBJECT TO CHANGE

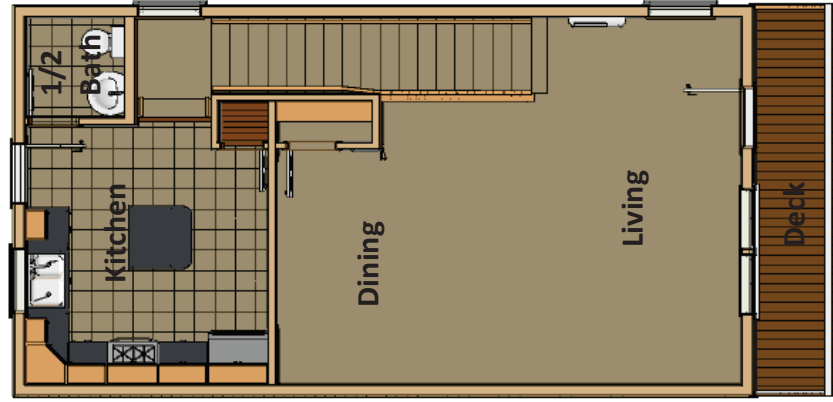

Main Floor



Second Floor

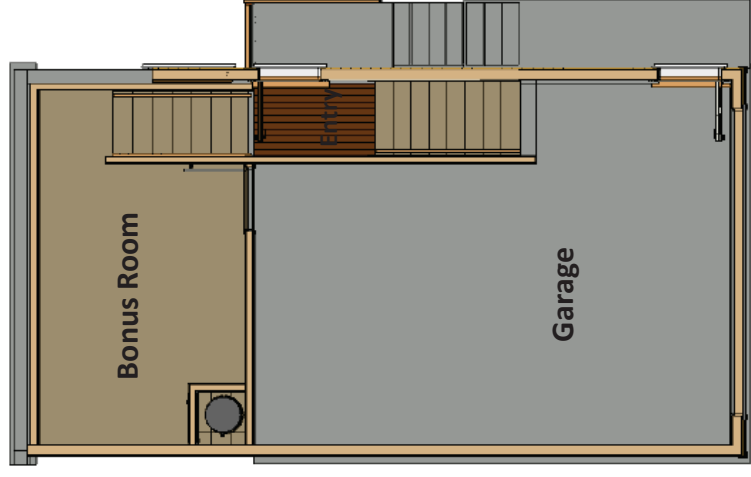

Basement/Ground Floor

